



Dali economic

The new generation in homecare

everything
in between is
configurable



Dali economic
basic



Dali economic
pro care

Strong advantages

- Choose between two standard configurations or configure your own Dali economic.
- The four-bed-stack saves freight costs and reduces the carbon footprint at the same time.
- With only 83 kg in the “pro care” version, it is an absolute lightweight! Maximum weight 15 kg of each individual bed part.
- Easy to assemble and set up.
- Excellent storability thanks to the four-stack system.

Customised according to your requirements

How to configure

Choose between our two on-stock versions for short term delivery or configure according to individual requirements with lead time.

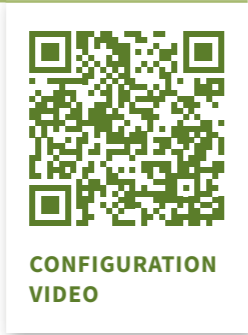

The Dali economic on the transport and storage aid fits effortlessly into any small Van or on a Pickup.



Four-stack with strong advantages:

- Sustainable and cost saving logistic
- Save up to 50% logistic costs
- Easy to unstack
- Unique solution designed by Burmeier

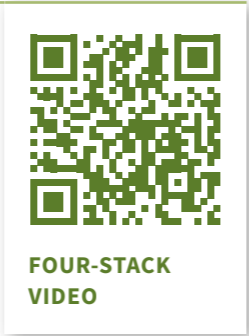

Handsets

Depending on the configuration, the appropriate handset can be selected. The "basic" and "pro care" versions are already equipped with a suitable handset. Additional handsets can be ordered as accessories for both versions.

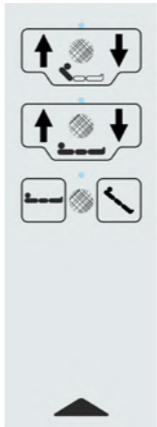

▲ HL 73 "Standard" included in basic version

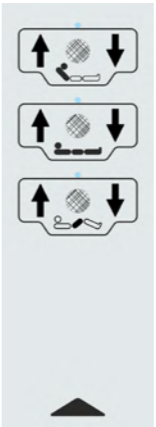

▲ HL 73 "pro care" included in pro care version

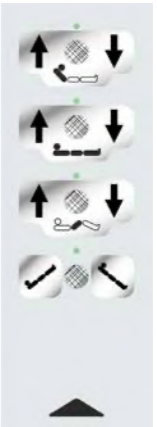

▲ HL 74 "Trendelenburg"

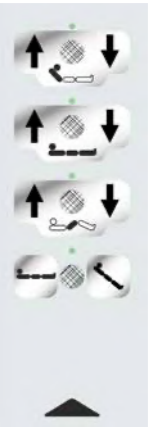

▲ HL 74 "Anti-Trendelenburg"



▲ HL 75 "Contour"

optional

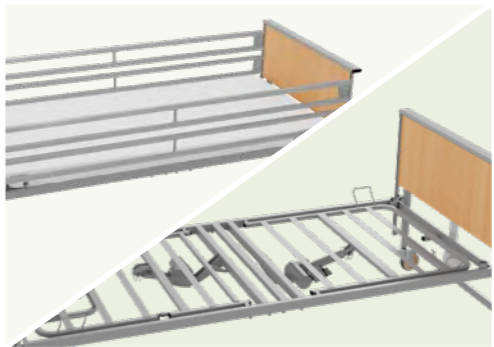

▲ Dali economic with metal safety sides and metal mattress base.



▲ Dali economic with wooden safety sides and wooden mattress base.

Technical data

Model		Dali economic basic ¹⁾	Dali economic pro care ¹⁾	Dali economic free configuration
Height adjustment range				
from – to	cm	40-80	40-80	40-80
Castors				
Single break		✓	✓	✓
Castor diameter	mm	100	100	100
External dimensions and weight				
Length	cm	218	218	218
Width	cm	101	101	101
Net weight	kg	64	83	X ²⁾
Safe working load	kg	185	185	185
Weight components Dali economic				weight [kg]
Mattress base head section				15
Mattress base foot section				15
Chassis				14
Patient lifting pole				6
Package, safety sides				11

Subject to technical changes without notice ✓ = Standard O = Available as an option – = Not available
¹⁾Short term delivery, minimum order quantity 4 pieces ²⁾Weight depends on the configuration

Equipment and options

Model	Dali economic basic ¹⁾	Dali economic pro care ¹⁾	Dali economic free configuration
Delivery			
Deliverable as 4-stack package	✓	✓	✓
Deliverable as 2-piece package	✓	✓	✓
Actuator			
Hight adjustment	✓	✓	✓
Backrest	✓	✓	✓
Lower leg rest	-	✓	0
Linak acuator system 24 V	✓	✓	✓
Mattress base			
Wooden slats	✓	✓	0
Metal slats	0	0	0
Saftey sides			
Wood	-	✓	0
Metal	-	-	0
Options			
Bed extension metal 20 cm	accessory ²⁾	accessory ²⁾	accessory ²⁾
Bed extension metal 20 cm with 4 saftey sides 220 cm	accessory ²⁾	accessory ²⁾	accessory ²⁾
Ratchet mechanism	accessory ²⁾	accessory ²⁾	accessory ²⁾
Tray	accessory ²⁾	accessory ²⁾	accessory ²⁾
Foam leather padding	accessory ²⁾	accessory ²⁾	accessory ²⁾
Handset HL 73 "standard"	✓	-	0
Handset HL 73 "pro care"	-	✓	0
Handset HL 74 "Anti-Trendelenburg"	-	0	0
Handset HL 74 "Trendelenburg"	-	0	0
Handset HL 75 "Contour"	-	0	0
4 safety sides	accessory ²⁾	✓	accessory ²⁾
Patient lifiting pole with handle bar	accessory ²⁾	✓	accessory ²⁾
Wooden surrounds	accessory ²⁾	accessory ²⁾	accessory ²⁾
Decor			
Natural Beech	✓	✓	✓

Subject to technical changes without notice ✓ = Standard 0 = Available as an option - = Not available ¹⁾Short term delivery, minimum order quantity 4 pieces ²⁾accessory = Not assembled and supplied as an extra package

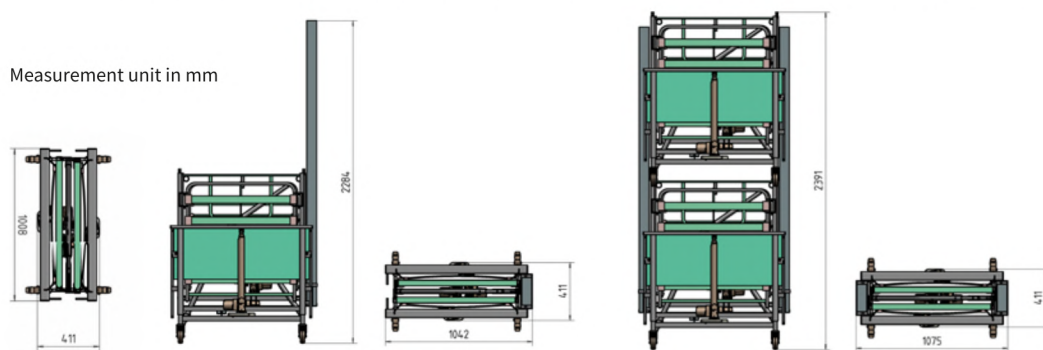

STIEGELMEYERGROUP
Solutions for people who care

Hauptsitz / Headquarters
Deutschland / Germany
Burmeier GmbH & Co. KG
Industriestraße 53
32120 Hiddenhausen
Phone +49 (0) 5223 9769 - 0
Fax +49 (0) 5223 9769 - 090
info@burmeier.com
www.burmeier.com

Hauptsitz / Headquarters
Deutschland / Germany
Stieglmeyer GmbH & Co. KG
Ackerstraße 42
32051 Herford
Phone +49 (0) 5221 185 - 0
Fax +49 (0) 5221 185 - 100
info@stieglmeyer.com
www.stieglmeyer.com

Distributor
EVOCARE AUSTRALIA PTY LIMITED

A.B.N. 98 078 566 604

Trading as **EVOCARE** and **L&M EQUIPMENT**

P.O. Box 145, Everton Park Qld. 4053

Ph: 07 3355 8000



Website: <http://www.evocare.com.au>

Email: sales@evocare.com.au

workshop@evocare.com.au

warehouse@evocare.com.au

accounts@evocare.com.au



stieglmeyer-group.com