

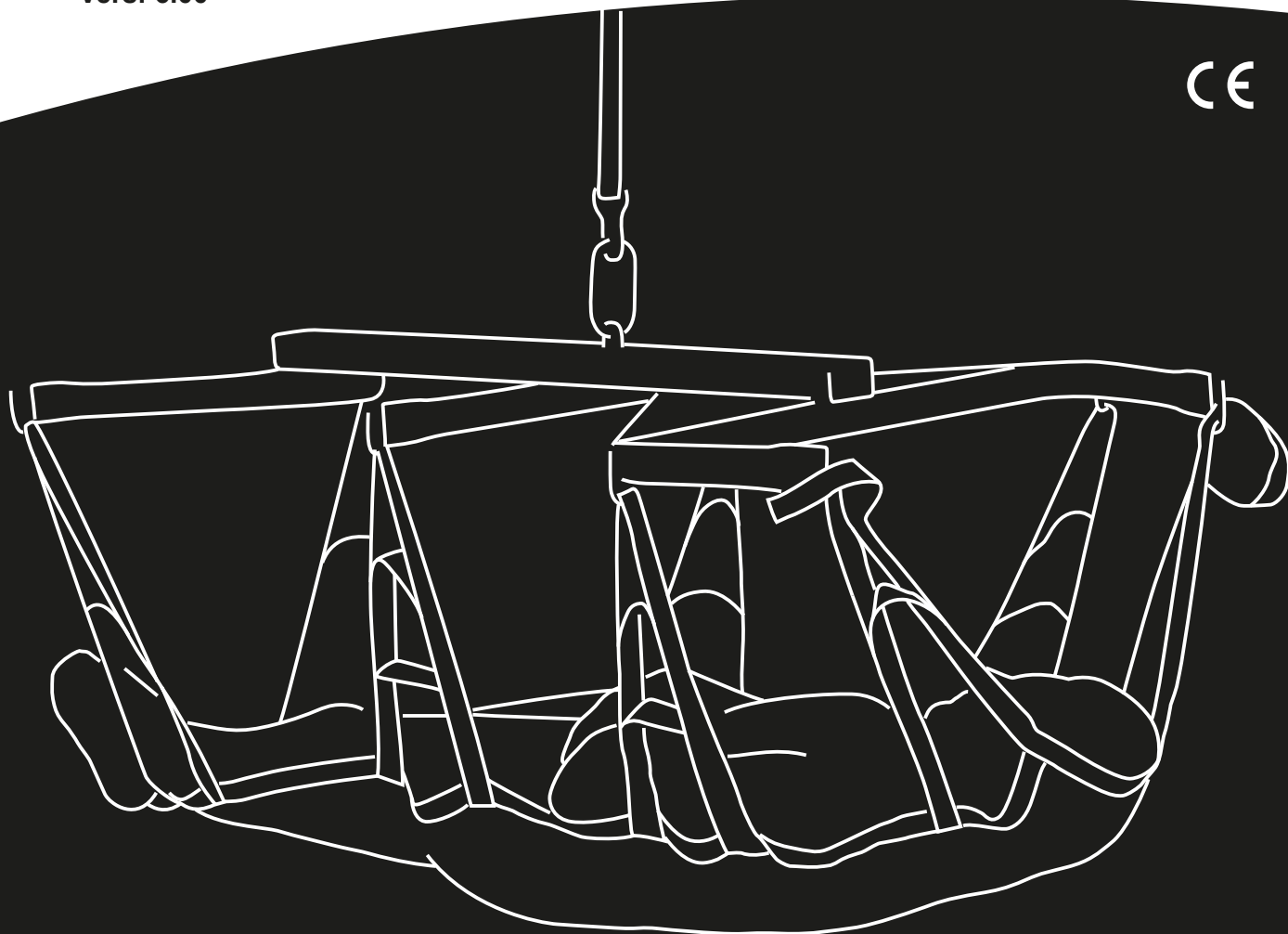

DK	Planløftebøjle, 375 kg	2
GB/US	Horizontal lifting support, 375 kg (825 lbs).....	10
DE.....	Liegebügel, 375 kg.....	19
SE.....	Planlyftbygel, 375 kg.....	28
FR.....	Support allongé, 375 kg	36
IT	Barella per sollevamento orizzontale, 375 kg.....	44
ES.....	Soporte de elevación horizontal, 375 kg.....	53
FI	Makuunostoliina, 375 kg.....	62

Vers. 6.00



Guldmann™

GB/US . . . Horizontal lifting support, 375 kg (825 lbs)

Vers. 6.00

Item nos:

28456 – with continuously variable weight adjustment

28466 – with 10 different lifting positions

1.00	Purpose and use	11
1.01	Manufacturer	11
1.02	Purpose	11
1.03	Important/warnings	11
1.04	Unpacking	12
1.05	Horizontal sling	12
2.00	Description of features	13
2.01	Labels	13
2.02	Functional description	13
2.03	Accessories	15
3.00	Maintenance	16
3.01	Cleaning and Maintenance	16
3.02	Replacement of components	16
3.03	Service life	16
3.04	Storage and use environment	16
3.05	Disposal of the Horizontal lifting support	16
4.00	Technical specifications	17
5.00	CE declaration of conformity	17
6.00	Environmental policy statement – V. Guldmann A/S	17
	USA and countries outside the EU	18
A.	Users guide	18
B.	WARRANTY	18

1.00 Purpose and use

1.01 Manufacturer

V. Guldmann A/S
Graham Bells Vej 21-23A
DK-8200 Aarhus N
Tel. +45 8741 3100
Fax +45 8741 3131

1.02 Purpose

The Horizontal lifting support is a lifting device which is used together with a Guldmann Ceiling hoist and rail system or Guldmann Mobile hoist to move a person in a horizontal position.

The Horizontal lifting support may be used only for horizontal relocation* of a person lying on a level, horizontal surface. A level surface can be, for example, a bed, a stretcher or the floor.

Conditions for use

The use of the Horizontal lifting support is subject to the following:

- The Horizontal lifting support is used by trained personnel.
- The helper pays attention to the well-being of the user when using the Horizontal lifting support.
- The Horizontal lifting support may be used only with a mobile lifter or a ceiling hoist and rail systems which have been tested and approved according to Guldmann's instructions.

** A horizontal relocation is defined as a relocation of a person lying on a horizontal surface where the horizontal position is kept during a vertical, horizontal or combined movement. The surface can be completely level or at an angle suited to the respective situation.*

1.03 Important/warnings

Always exercise caution when using the Horizontal lifting support. This means that helpers should always make sure that they, the user and any other persons are safe in order to avoid injuries or accidents.

- Please read the user manual before starting the use of the Horizontal lifting support.
- Do not exceed the recommended safe working load of the Horizontal lifting support.
- Products marked with the lowest lifting capacity determine the maximum load.
- Use the Horizontal lifting support only to move a person "in a horizontal or angled position".
- If a defect appears during use of the Horizontal lifting support, stop using it and contact the Guldmann Service Team for repair.
- The user in the Horizontal lifting support must always be under supervision and may not turn or move in the lengthwise direction when lying in the lifter.

- To avoid unintentional movements of the user, the helper must position the hoist and the Horizontal lifting support centrally over the user before lifting is started.
- When the Horizontal lifting support is lowered with a user in it, the Horizontal lifting support may never rest on the user.

1.04

Unpacking

Visual check of the Horizontal lifting support

If the Horizontal lifting support is thought to be damaged upon receipt, it must not be used before it is checked and approved by a qualified person or the Guldmann Service Team.

The contents of the box

- Horizontal lifting support
- Oval hook

1.05

Horizontal sling

When working with a Horizontal lifting support

Attention should be paid to the functional level of the user and the work technique of the helper. The user should be lifted only to the extent that she/he is clear of the surface and then moved at this height.

The Horizontal lifting support is to be used with a lifting sling with eight straps (item number 28463) that are attached to hooks on the Horizontal lifting support. For proper fitting and use of the lifting sling, please refer to the product manual for this sling.

Warning!

Please exercise caution when positioning the sling straps on the Horizontal lifting support. Verify that the sling straps have been correctly positioned onto the hooks in the Horizontal lifting support. When pressing the arrow up button on the hand control you should verify once more that the sling straps remain in the correct position in the horizontal lifter hooks (Fig. 1).

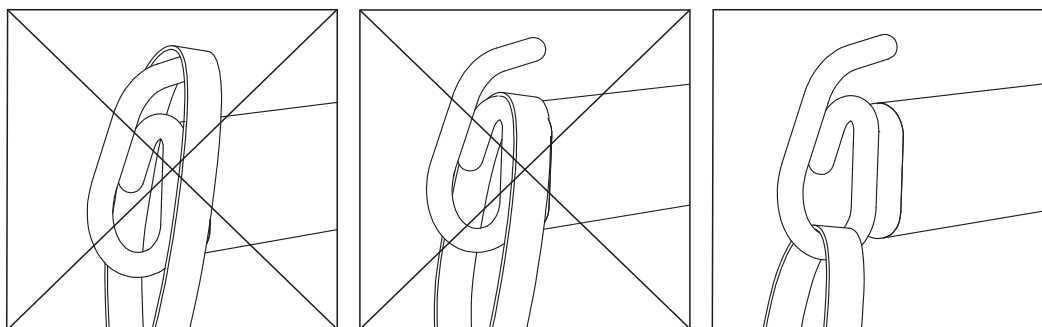
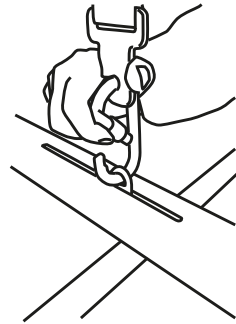

Fig. 1

Horizontal sling from another manufacturer

Guldmann disclaims any responsibility for defects or accidents which may occur when slings or horizontal slings made by other manufacturers are used. In case of doubt concerning the selection or use of a horizontal sling, please contact your supplier. Guldmann disclaims any responsibility for defects or accidents which may occur as a result of incorrect use of the Horizontal lifting support and horizontal sling, or because of lack of attention on the part of the caregiver or the user.

The Horizontal lifting support must be securely attached to either snap hook (GH2) or Oval hook (GH3 & Mobile lifter), make sure that the hooks are properly closed.



2.00 Description of features

2.01 Labels

ID number label

Guldmann™
No. 28466-1001-2016
max 375 kg/825 lbs
V. Guldmann A/S, Graham Bells Vej 21-23A
DK-8200 Århus N, Tel. +45 8741 3151 **CE**

Guldmann™
No. 28456-1001-2016
max 375 kg/825 lbs
V. Guldmann A/S, Graham Bells Vej 21-23A
DK-8200 Århus N, Tel. +45 8741 3151 **CE**

2.02 Functional description

1. Horizontal lifting support with continuously variable weight adjustment
2. Horizontal lifting support with 10 different lifting positions
3. Oval hook
4. Weight adjustment handle
5. Swivel link GH2/GH3, spare part (Not included)

**1. Horizontal lifting support
with continuously variable weight adjustment**

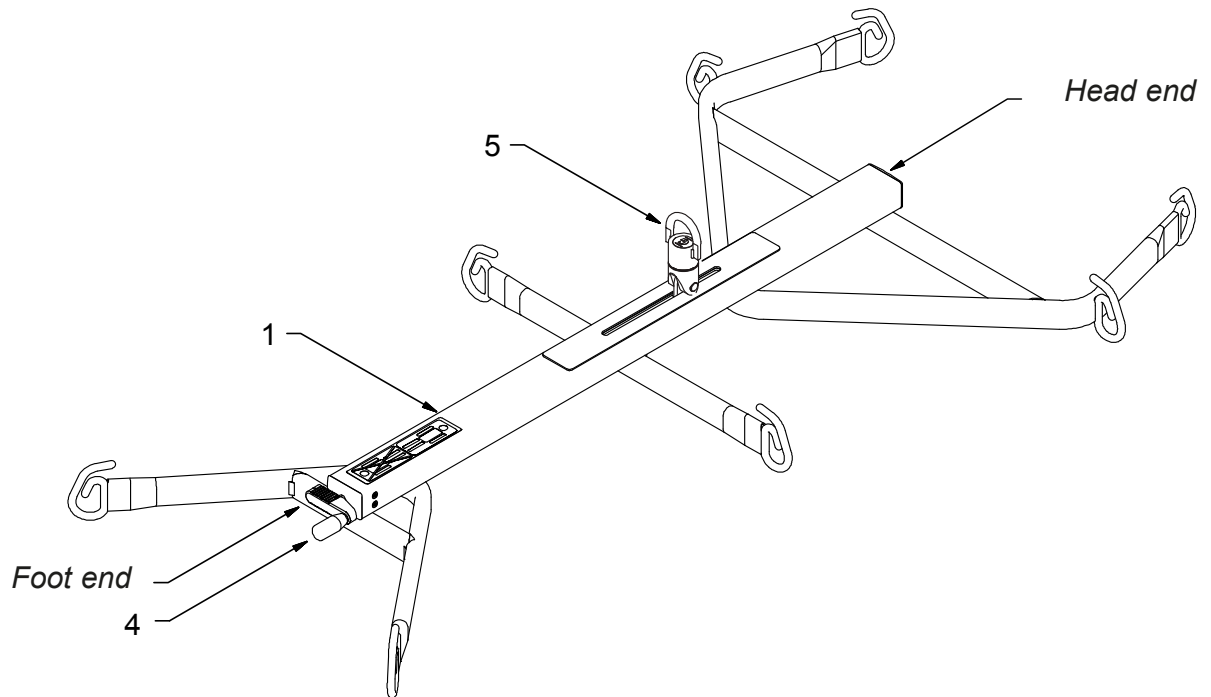

**2. Horizontal lifting support
with 10 different lifting positions**

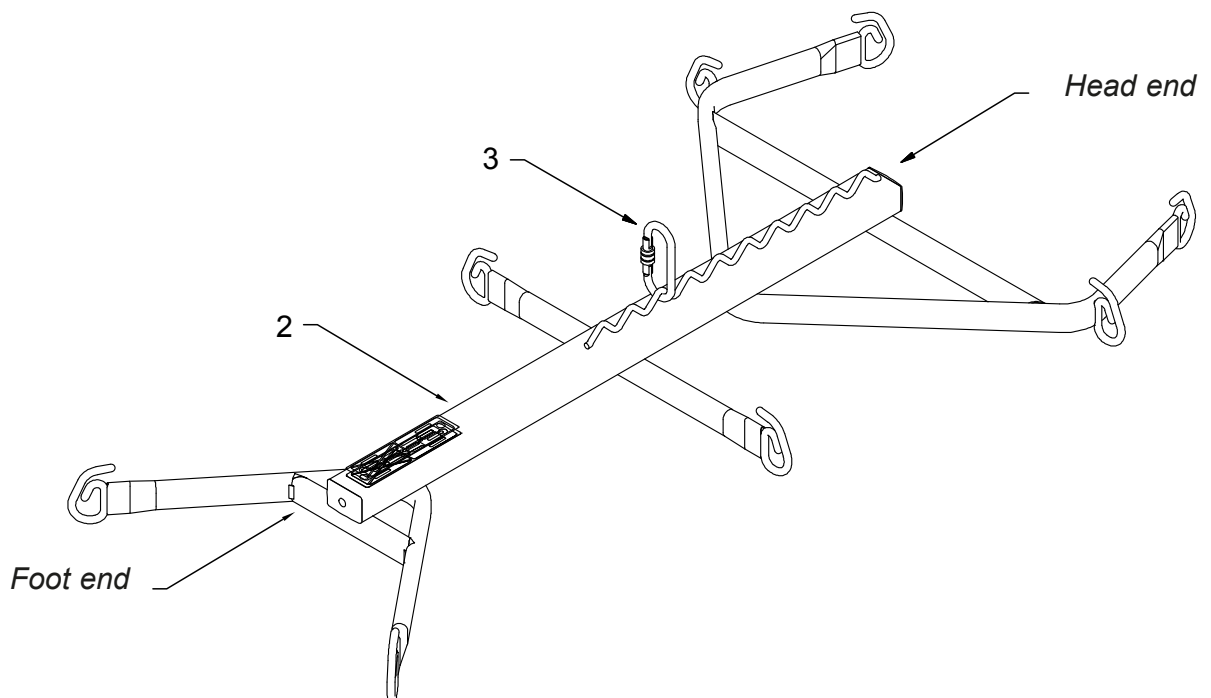

Attach the Horizontal lifting support to the hoist with the oval-shaped hook (pos. 3) or with the swivel (pos. 5).

On the model with continuously variable weight adjustment, the weight adjustment feature can be activated by turning the hand grip (pos. 4) clockwise to lower the head end and counterclockwise to raise the head end.

On the model with 10 different lifting positions, the weight can be adjusted by moving the hook/swivel to another suspension point – closer to the head end to raise the head end and closer to the foot end to lower the head end.

Horizontal lifting support used with Twin hoist

Installation of Horizontal lifting support

Place each of the lifting straps' oval hooks in the first eye of the Horizontal lifting support, one on each side.

The Horizontal lifting support can be aligned to the horizontal plane by adjusting the twin hoist's tilt function. For more information see the twin hoist manual.

Important

Check that none of the lifting straps are twisted after the installation of the Horizontal lifting support.

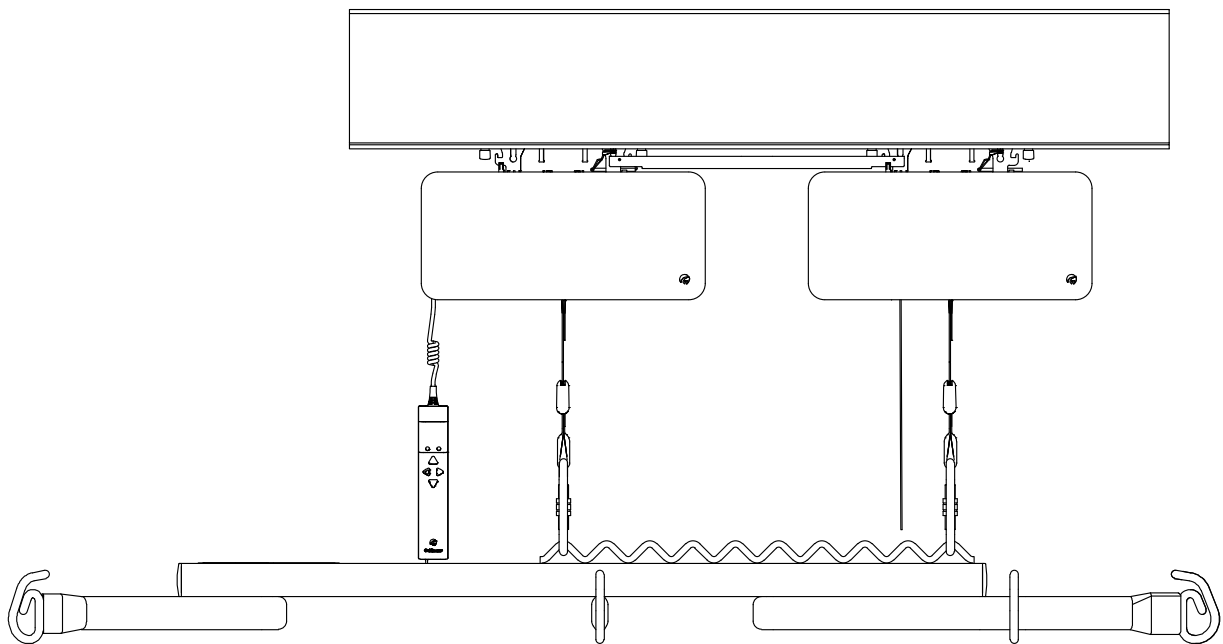

2.03

Accessories

Horizontal sling for Horizontal lifting support	Item no. 28463
Oval hook	Item no. 21160
Swivel link GH2/GH3, spare part	Item no. 284520
Wall mounted parking space for Horizontal lifting support	Item no. 556968

3.00 Maintenance

3.01 Cleaning and Maintenance

The Horizontal lifting support is made of powder coated steel and resistance materials.

To ensure a proper appearance and long lifetime of the horizontal lifting support, it is recommended to follow these guidelines:

- Ordinary cleaning of the Horizontal lifting support is conducted with a damp cloth and ordinary detergent.
- Cleaning with strong detergents may only be applied on the Horizontal lifting support's exterior with a damp cloth.
- Do not use an autoclave.

The Horizontal lifting support does not need any additional maintenance apart from ordinary cleaning.

3.02 Replacement of components

Components may be replaced only by a qualified service technician or the Guldmann Service Team.

3.03 Service life

The Horizontal lifting support has an expected service life of 10 years, when subjected to continuous maintenance.

3.04 Storage and use environment

The Horizontal lifting support is designed for indoor use.

Temperature +5 to 40 C°

Humidity <95% (not condensing)

Keep the Horizontal lifting support in a dry room for long-term storage.

Guldmann recommends to store the Horizontal lifting support on a wall mounted parking space when not in use.

3.05 Disposal of the Horizontal lifting support

Local and national regulations on environmentally correct recycling must be observed.

4.00 Technical specifications

Horizontal lifting support with continuously variable weight adjustment
Lifting capacity max 375 kg (825 lbs)
Weight 11,6 kg (25.5 lbs)

Horizontal lifting support with 10 different lifting positions
Lifting capacity max. 375 kg (825 lbs)
Weight 10,9 kg (24 lbs)

Dimensions

Horizontal lifting support (W x H x L). 716 x 110 x 1425 mm

Materials

Horizontal lifting support Powder coated iron & Plastic LDPE

5.00 CE declaration of conformity

The product is manufactured in compliance with the Council Directive 93/42/EEC of June 14th 1993, including amendments, as medical device class 1.

6.00 Environmental policy statement – V. Guldmann A/S

Guldmann is continuously working towards ensuring that the company's impact on the environment, locally and globally, is reduced to a minimum.

It is Guldmann's goal to:

- Comply with the current environmental legislation (e.g. WEEE and REACH directives)
- Ensure that we, at the widest possible range, use RoHS compliant materials and components
- Ensure that our products do not have an unnecessary negative impact on the environment regarding use, recirculation or disposal
- Ensure that our products contribute to a positive working environment in the places they are utilised

Inspections are made annually by the Department for Nature and Environment from the Municipality of Aarhus using the Danish Environmental Protection Act, section 42 as a reference.

USA and countries outside the EU

A. **Users guide**

Before using the product, read the entire operation manual including warranty.

B. **WARRANTY**

Guldmann warrants its equipment is free from material defects under normal use, and will perform substantially in accordance with the specifications set forth in documentation provided with the equipment.

This express warranty shall be in effect for one year from the date of original purchase and installation (the "Warranty Period"). If a valid claim is made during the Warranty Period for malfunction or equipment defect, Guldmann will repair or replace the equipment at no additional cost to you. Guldmann retains sole discretion as to whether the equipment will be repaired or replaced.

This warranty shall be null and void if the equipment is operated and maintained in any manner inconsistent with its intended use or the instructions provided with the product. Further, in order for the warranty to remain in effect for the full Warranty Period, all service to the equipment must be provided by a Guldmann designated technician. Any parts or components repaired or replaced by a Guldmann designated technician will be guaranteed for the remainder of the Warranty Period.

The warranty does not cover any part of the equipment which has been subject to damage or abuse by the user or others. The warranty does not cover any part of the equipment which has been altered or changed in any way by the user or others. Guldmann does not warrant that the lifting device functions will meet your requirements, be uninterrupted or error free.

The warranty set forth is in lieu of all other express and implied warranties, whether oral, written or implied, and the remedies set forth above are your sole and exclusive remedies. Only an authorized officer of Guldmann may make modifications to this warranty, or additional warranties binding on Guldmann. Accordingly, additional statements such as advertising or presentations, whether oral or written, do not constitute warranties by Guldmann.

Service or Repair

Contact Guldmann Repair for an authorization to return any defective item during the Warranty Period. You will be provided with a return authorization number and address for returning the item for warranty service or replacement. Do not return items to Guldmann under warranty without receiving a Return Authorization Number.

If mailing the item, pack it carefully in a sturdy carton to prevent damage. Include your Return Authorization Number, a brief description of the problem and your return address and phone number. Guldmann does not assume the risk of loss or damage while in transit, so it is recommended you insure the package.

| Time to care |

V. Guldmann A/S

Head Office:
Graham Bells Vej 21-23A
DK-8200 Aarhus N
Tel. +45 8741 3100
Fax +45 8741 3131
info@guldmann.com
www.guldmann.com

Guldmann GmbH

Unter den Eichen 5
D-65195 Wiesbaden
Tel. +49 611 974 530
Fax +49 611 300 018
info@guldmann.de
www.guldmann.de

Guldmann Sverige AB

Smålandsgatan 4
S-441 57 Alingsås
Tel. +46 0322 55290
Fax +46 0322 55320
info@guldmann.se
www.guldmann.se

Guldmann Sarl

5 bis rue Gabriel Péri
F-92120 Montrouge
Tél. +33 145 54 78 36
Fax +33 145 57 10 52
france@guldmann.com
www.guldmann.fr

Guldmann Srl

Via Focherini 7
I-43058 Sorbolo (PR)
N° Verde 800 781 604
Tel. +39 0521 660132
Fax +39 0521 691399
Cell. +39 340 9087107
italia@guldmann.com
www.guldmann.it

Guldmann Inc.

14401 McCormick Drive
Unit A
Tampa, FL 33626
Tel. 800 664 8834
Tel. 813 880 0619
Fax 813 880 9558
info@guldmann.net
www.guldmann.net