

Medication Cart

User Manual



4/10 Uppill Place Wangara WA 6065



Medication Carts

Manual Lock Operating Instructions	3
Locking the Cart	4
Unlocking the Cart	5
Lock and Key Replacement.....	6
Manual Override Opening Procedure	7
Assembly Diagrams	8 & 9
Warranty	10

Manual Lock Operating Instructions

OVERVIEW

The cart has been fitted with a manual operated lock with key access, the lock controls access to the drawers. When the cart is unlocked the drawers should open freely with little resistance. If the drawers do not open freely do not force them, check that the cart is unlocked correctly. If the lock is faulty check with a service technician.

Handle
Key
Lock body



Locking the Cart

Turn the handle clockwise until it stops in the vertical position.

Turn the key clockwise 90°, the cart is now locked. Remove the key and keep it in a safe place.

See figure 2.1 & 2.2 below

Rotate Handle Clockwise

Rotate Key Clockwise



Figure 2.1



Figure 2.2 Locked position with key removed

Unlocking the Cart

Turn the key 90Deg anti-clockwise until it stops in the vertical position.

Turn the handle anti-clockwise until it stops, the cart is now unlocked and the drawers are free to open.

See figure 3.1, 3.2 below

Rotate Handle Anti-Clockwise

Rotate Key Anti-Clockwise



Figure 3.1

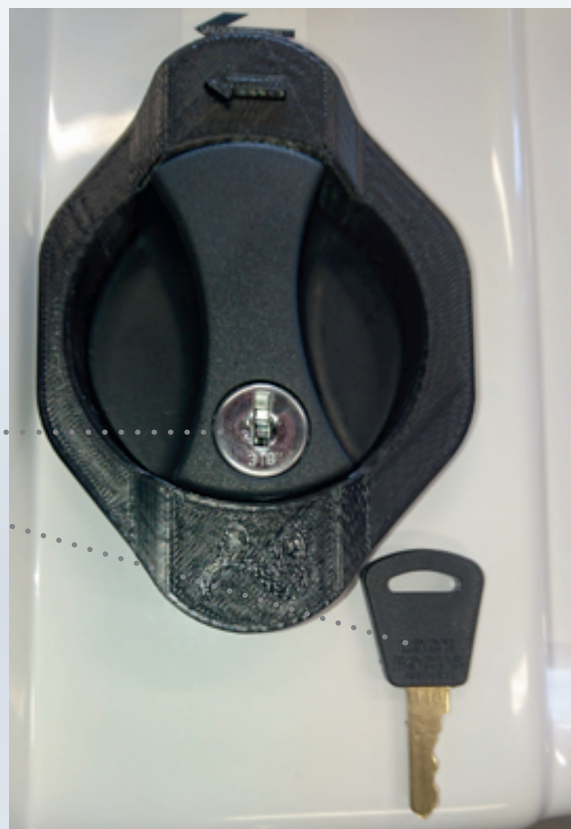

Figure 3.2 Unlocked position with key removed

Lock & Key Relacement

The key and the barrel on the lock body have 3 numbers stamped on them with the last two numbers matching.

Number Placement



CLEANING AND DISINFECTION

Clean all exposed surfaces and remove organic debris by wiping with a moistened soft textured cloth with low strength detergent and warm water. Dry thoroughly with a clean cloth.

Non-phenolic disinfectants are recommended in a diluted solution. Wipe the cleaned surfaces with the solution, rinse and dry thoroughly with a clean cloth.

Do not allow liquids to enter the lock. Do not use acids, alkaline, or other chemical solvents. Do not use abrasives, scourers and other coarse materials which could damage the coatings.



**If you experience any difficulties,
please contact our customer service helpline
Freecall: 1300 525 520**

Manual Override Opening Procedure

**This document is for use in an emergency only.
It is not to be distributed by unauthorised personal.**



Step 1

The lock rail is located at the rear left hand corner of the cart.

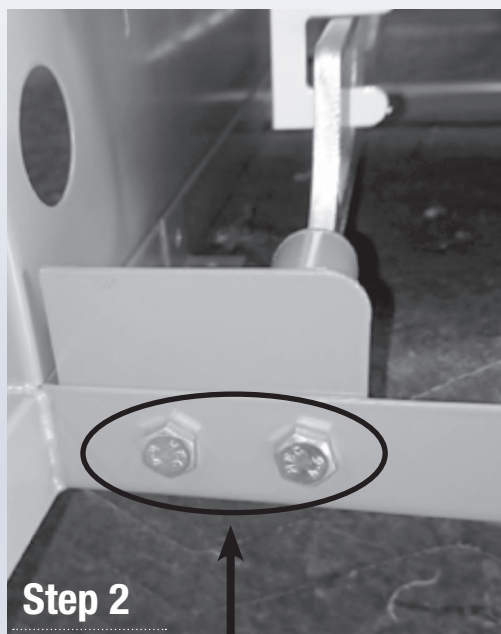

Step 2

On the underside of the frame work there are 2 bolts. Unscrew both bolts and slide the rail mount plate to the side so the drawer locking tab is free from the rail. This will enable the drawers to be opened to remove and gain access to the lock.

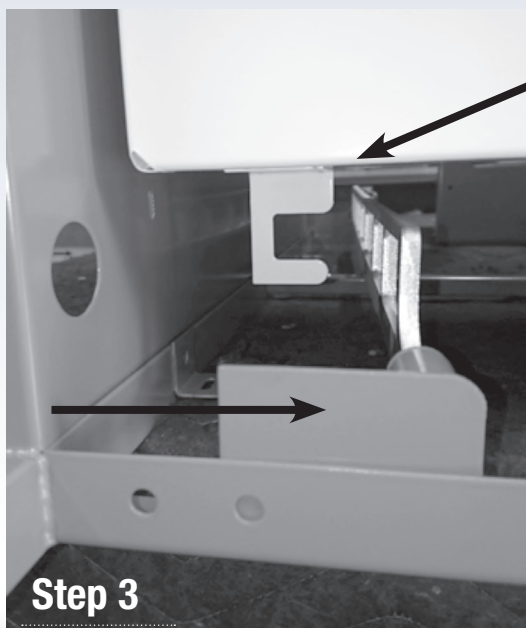

Step 3

The lock will have to be inspected by a service technician to fix the fault.

ITEM NO.	PART NUMBER	DESCRIPTION	QTY.
1	500LRE	LOCKING RAIL ECONOMY	1
2	500LRT	LOCKING RAIL TAB	1
3	500LRBT	LOCKING RAIL BUSH TOP	1
4	500LRBB	LOCKING RAIL BUSH BOTTOM	1
5	500LRCRE	LOCKING RAIL CONNECTING ROD - M5 ALL THREAD	1
6	RE5FR	ROD END M5 FEMALE R/H	2
7	W5Z	WASHER FLAT Z/P M5	2
8	B516ZH	M5 X 16 Z/P HEX BOLT	2
9	500MLT	MANUAL LOCK TAB	1
10	N5Z	M5 HEX NUT ZIP	2
11	NN5Z	M5 NYLOC NUT ZIP	1

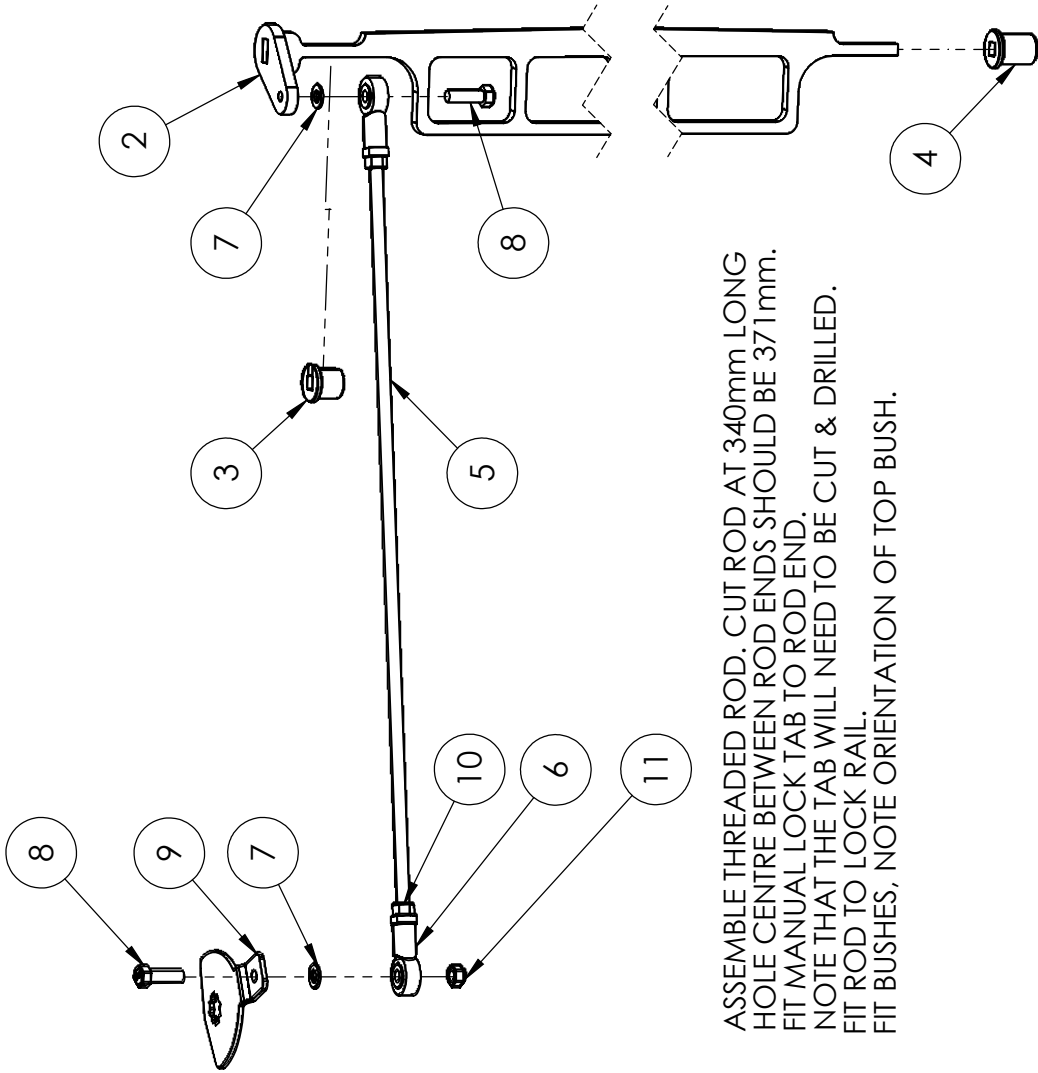

1. ASSEMBLE THREADED ROD. CUT ROD AT 340mm LONG. HOLE CENTRE BETWEEN ROD ENDS SHOULD BE 371 mm.
2. FIT MANUAL LOCK TAB TO ROD END.
3. NOTE THAT THE TAB WILL NEED TO BE CUT & DRILLED.
4. FIT ROD TO LOCK RAIL.

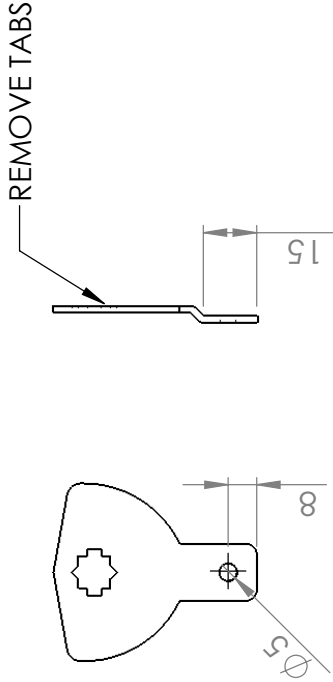

4Healthcare 4/10 Uppili place Wangara, 6065 P:93092096 F:93092053	TITLE: MEDICATION CART LOCKING RAIL ECONOMY - ASSEMBLY	
	DWG NO. 4S500LRE	
MATERIAL: THICKNESS: PROCESS: ASSEMBLY	REVISION 1	
	DO NOT SCALE DRAWING	
DRAWN: JB	NAME: JB	DATE: 13/10/15
REV: 1	REV: 1	REV: 1
SHEET 1 OF 1	SHEET 1 OF 1	SHEET 1 OF 1

ITEM NO.	PART NUMBER	DESCRIPTION	QTY.
6	500PT	PLASTIC TOP	1
19	4S500ML	MANUAL LOCK	1
20	500MLSW	MANUAL LOCK SPRING WASHER	1
21	500MLLP	MANUAL LOCK LOCKING PLATE	1
22	W5Z	WASHER FLAT ZIP M5	2
23	SP8G15ZP	SCREW PAN HEAD 8G x 15 LONG ZP	2
24	PLASTIC TOP DOUBLE SIDED TAPE	PLASTIC TOP DOUBLE SIDED TAPE	1
27	RIV4-4	4-4 RIVET	2

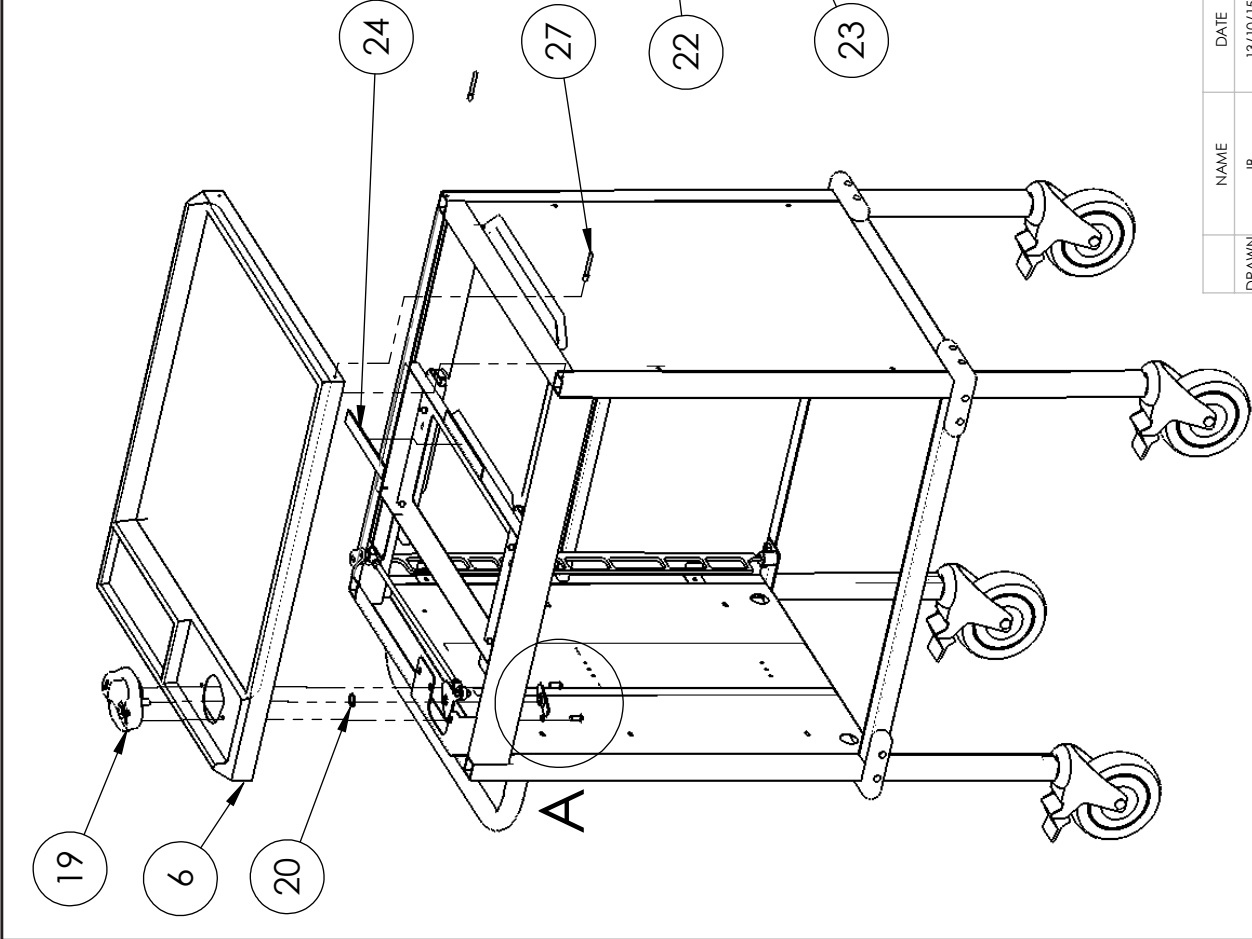

DETAIL A

<div> <div>4Healthcare</div> <div>4/10 Uppill placeWangara, 6065 P:93092096 F:93092053</div> </div>	<div> <div>TITLE:</div> <div>MEDICATION CART ECONOMY</div> </div>	
	<div> <div>DWG NO.</div> <div>4H503E - ASSEMBLY DWG 03</div> </div>	<div> <div>A4</div> </div>
<div> <div>DRAWN</div> <div>JB</div> </div>	<div> <div>DATE</div> <div>13/10/15</div> </div>	<div> <div>REV</div> <div>1</div> </div>
<div> <div>MATERIAL:</div> <div>THICKNESS:</div> <div>PROCESS: ASSEMBLY</div> </div>		
<div> <div>DO NOT SCALE DRAWING</div> <div>REVISION 1</div> </div>		<div> <div>SHEET 1 OF 1</div> </div>

4Healthcare warrants that its products are free from defects in workmanship, materials and will repair / replace defective components (excluding batteries) from the purchase date of the manufacture of the products for 24 months.

All service and repairs must be carried out by 4Healthcare or a certified 4Healthcare trained Technician. 4Healthcare will not be responsible for any expenses, inconvenience or incidental damages occasioned by the use, loss of use, or misuse of the products, or by failure of the products to conform to the warranty set forth above.

This warranty becomes void if the product shows evidence of mishandling, tampering, installation or use contrary to the application instruction material, shipping damage, or repair performed by other than a service personnel authorised by 4Healthcare.

Routine cleaning, adjustment and normal cosmetic and mechanical wear are not covered by this warranty. Prompt and written notice is required for a warranty claim.

Note: Batteries are not covered under this warranty as their life is mostly dependent on the operator ensuring continual and regular charging.

No part of this publication may be reproduced without the prior written permission of 4Healthcare Pty Ltd.



Distributor

EVOCARE AUSTRALIA PTY LIMITED

A.B.N. 98 078 566 604

Trading as **EVOCARE** and **L&M EQUIPMENT**

P.O. Box 1144, Stafford Qld. 4053

Ph: 07 3355 8000 Fax: 07 3355 5043

Website: <http://www.evocare.com.au>

Email: sales@evocare.com.au

workshop@evocare.com.au

warehouse@evocare.com.au

accounts@evocare.com.au

