

COMFORT SLING

INCLUDING COMFORT PAD® AND SECURIS CLIP SYSTEM

USER GUIDE FOR THE COMFORT SLING

The Comfort Sling is an easy fit, contoured sling designed to accommodate 85-90% of clients. It is used in conjunction with the 4 point spreader bar which is designed to position patients from either a seated or reclined position. The sling is available in five sizes - extra large, large, medium, small and paediatric.

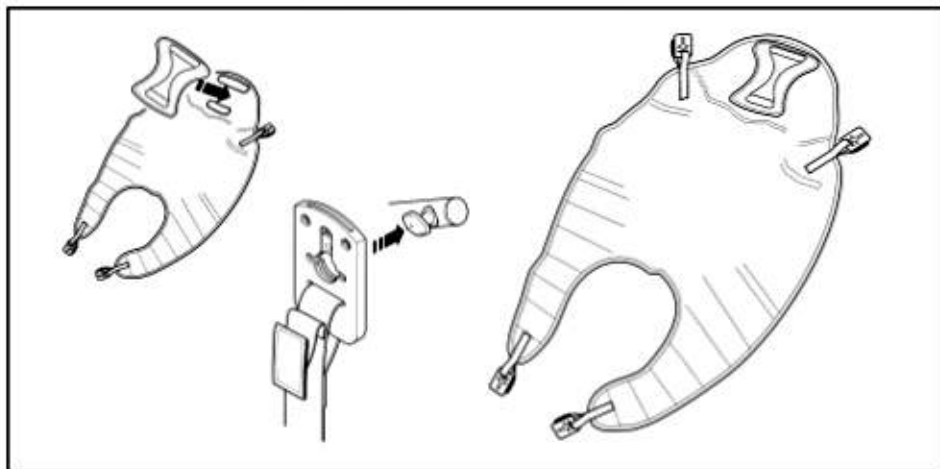

OXFORD RECOMMENDS THE USE OF GENUINE OXFORD PARTS.

Oxford sling and lift products are designed to be compatible with one another. For country specific guidance on sling use and compatibility, please refer to the sling label or contact your local market distributor or Joerns Healthcare.

For the safety of the patient and carer: before using a sling a full risk assessment must be conducted to ensure that the correct sling choice, method of positioning in the sling and procedure for transfer has been determined for the patient.

Check sling and stitching before each use. Using bleached, torn, cut, frayed or broken slings is unsafe and could result in serious injury or death to the patient.

Destroy and discard worn slings. Do not alter slings.

Never leave a patient unattended.



ADDITIONAL SLINGS ARE AVAILABLE TO SUIT INDIVIDUAL NEEDS.
 YOU ARE ADVISED THAT YOU SHOULD ALWAYS SEEK THE ADVICE OF AN
 AUTHORISED DEALER BEFORE PURCHASING.

WE WILL BE PLEASED TO ADVISE YOU OF YOUR NEAREST AUTHORISED DEALER.

HOW TO FIT FROM SEATED POSITION

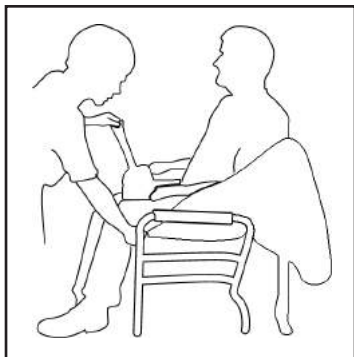

The comfort sling is fitted to the patient in the traditional way. Fitting from the seated position requires the carer to raise the client's leg and feed the leg support piece under and up between the legs. Repeat this procedure for other leg. Ensure the sling is not twisted or creased under the thigh. Bring both leg pieces together and feed through the modesty strap.

Position the rear section of the sling up and around the shoulders and head, the client is then ready for lifting.

HOW TO FIT SLING FROM LYING POSITION

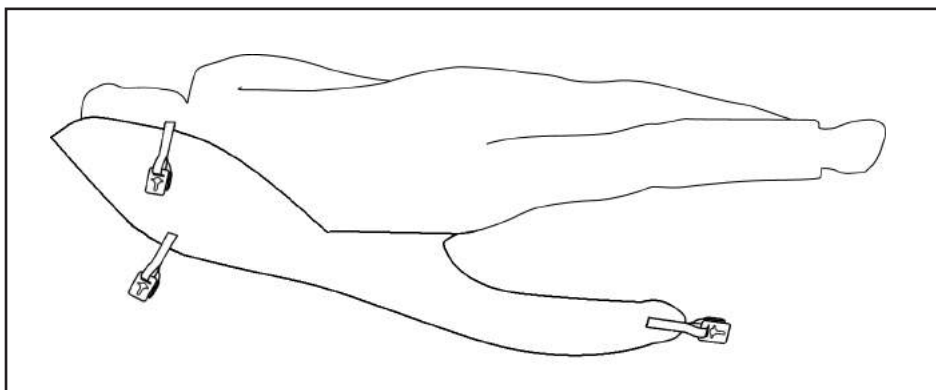

Draw sheet roll the client onto the sling, ensuring that the top of the commode aperture is at the base of the spine. Position the spreader bar as shown opposite and the client is ready for lifting.

GOLDEN TIPS

- 1. THE CLIENT'S POSTURE CAN BE ALTERED PUSHING DOWN ON SPREADER BAR PIVOT HANDLE (SEE OPPOSITE).**
- 2. ATTACH SECURI3 CLIPS TO THE SPREADER BAR AS DESCRIBED OPPOSITE.**
- 3. ENSURE ALL GREEN SAFETY LOOPS ARE VISIBLE BEFORE LIFTING.**

HOW TO FIT THE SLING TO THE 4 POINT SPREADER BAR

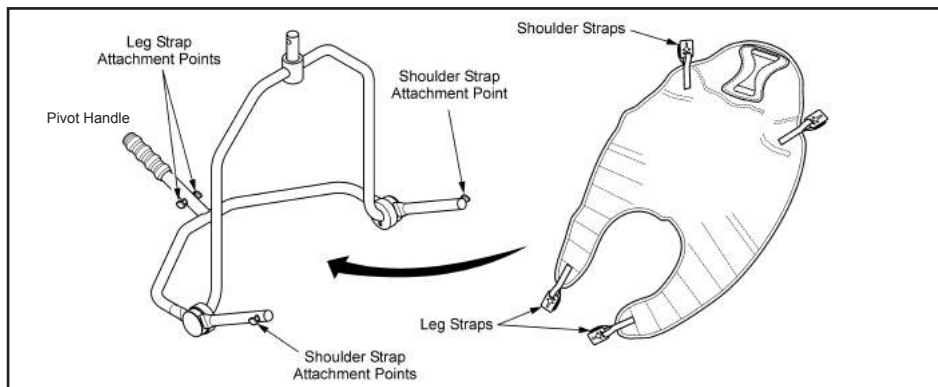

When fitted to the patient, the sling is connected to the 4 point spreader bar by using the Securi3 clip system (step by step guide as follows). To remove, simply reverse this procedure.

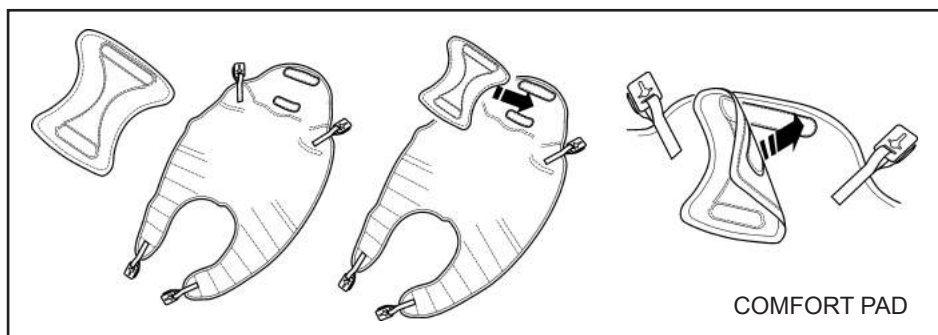
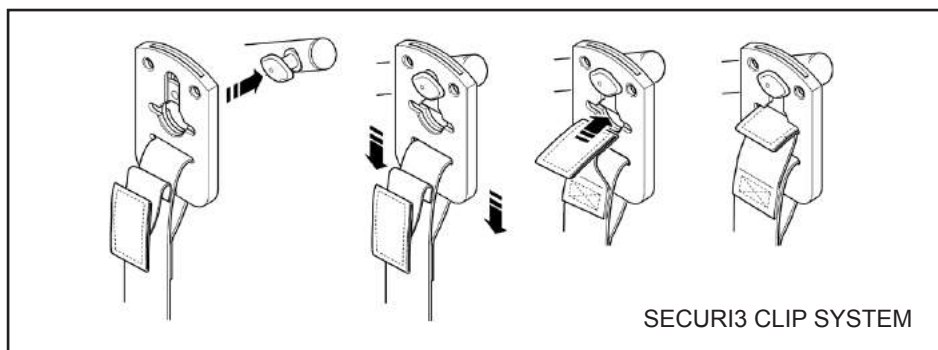

The Comfort Pad must be applied as it provides additional comfort and support to the client. **Do not** lift without the Comfort Pad correctly in position. The Comfort Pad is available in different thicknesses providing increased levels of support/comfort.

COMFORT SLING TECHNICAL SPECIFICATIONS

STANDARD	BS EN ISO 10535
SAFE WORKING LOAD	500lbs / 227kg

SIZING

Each sling is marked with the following colour coded symbols, four of which will be crossed. Your sling is the uncrossed size, i.e. in this example Small (Red).

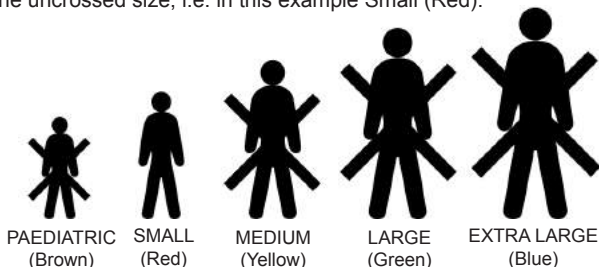

WASHING INSTRUCTIONS

Each sling is marked with the following washing instructions:

DO NOT WASH WITH BLEACH

Bleach will damage material. Slings can suffer damage during washing and drying. Check sling before each use. Bleached, torn, cut, frayed or broken slings are unsafe and could result in serious injury or death to patient. Destroy and discard worn slings. Do not alter slings. Machine wash warm. Cool tumble dry, air dry or dry at very low temperature.



		Comfort (Polyester)	Comfort Padded (Polyester)	Comfort (Net)
ORDER CODE	PAEDIATRIC (BROWN)	SL25501	SL25506	SL25511
	SMALL (RED)	SL25502	SL25507	SL25512
	MEDIUM (YELLOW)	SL25503	SL25508	SL25513
	LARGE (GREEN)	SL25504	SL25509	SL25514
	EXTRA LARGE (BLUE)	SL25505	SL25510	SL25515



Joerns Healthcare Limited
 Drakes Broughton Business Park, Worcester Road
 Drakes Broughton, Pershore, Worcestershire
 WR10 2AG United Kingdom
 Tel: 0844 811 1156 • Fax: 0844 811 1157
 info@joerns.co.uk • www.joerns.co.uk

