



## GH3 Twin Lifting module Technical specifications

### Weight and materials

|            |                          |
|------------|--------------------------|
| SWL        | : 250 kg, 375 kg, 500 kg |
| Own weight | : 19,2 kg                |

Covers : Impact-resistant UL 94 V-0 flame retardant recyclable plastic

### Dimensions

|                |           |
|----------------|-----------|
| A              | : 860 mm  |
| B              | : 817 mm  |
| C              | : 156 mm  |
| D              | : 184 mm  |
| E, min         | : 655 mm  |
| F, max         | : 3155 mm |
| G              | : 473 mm  |
| Depth of hoist | : 205 mm  |

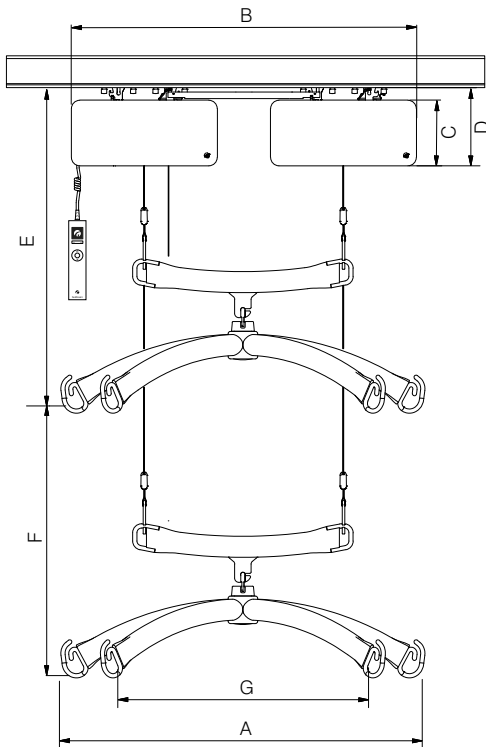

### Functions

|             |                     |
|-------------|---------------------|
| Operation   | : Hand control / IR |
| Sound level | : 52 dB (A)         |

### Safety

|                           |   |
|---------------------------|---|
| Emergency stop            | : Yes                                       |
| Emergency lowering device | : Yes, mechanical and electrical            |
| Control of lifting strap  | : Yes                                       |
| Cut-off angle             | : 45° along the rail<br>10° across the rail |

### Electronics

|                             |  |
|-----------------------------|--|
| On/off                      | : Automatic when used. Soft start/stop. Overload protection.   |
| Battery                     | : 24 V NiMH, 2 x 2.1 Ah  |
| Max charge time             | : 4 hours  |
| Battery protection          | : At battery voltage below 22 V the indicator light turns orange. The hoist is stopped if the voltage falls below 20 V |
| Power supply                | : 33 V AC, 2.5 A   |
| Supply voltage, transformer | : 100-240V AC  |

### Protection classification (IP) according to IEC 60529

|                |         |
|----------------|---------|
| Lifting module | : IP 20 |
| Hand control   | : IP 44 |
| Remote control | : IP 20 |
| Transformer    | : IP 20 |

### Labelling

The product is manufactured in compliance with regulation (EU) 2017/745 of the European parliament and of the Council of 5 April 2017, as medical device Class I.

### Classification

Pursuant to ISO 9999

### Patents

|                 |
|-----------------|
| : PA 2008 00888 |
| : PA 2008 00894 |
| : PA 2008 00895 |

Time to care



## GH3 Twin Lifting module Technical specifications

| GH Lifting modules, configurations |              |            |                          |                          |                                   | Options                    |                |            |              |             |                 |                |         |                  |    |           |
|------------------------------------|--------------|------------|--------------------------|--------------------------|-----------------------------------|----------------------------|----------------|------------|--------------|-------------|-----------------|----------------|---------|------------------|----|-----------|
| Guldmann hoist type                | Product line | Load in kg | Number of lifting straps | Number of lifting motors | Number of horizontal drive motors | IR remote                  | Service module | CLM module | Scale module | WiFi module | Class III scale | Trainer module | Coating | Excl. Turbospeed | UL | Charg. HC |
| GH3                                | (x)          | xxx        | x                        | x                        | x                                 | Configuration code (xxxxx) |                |            |              |             |                 |                |         |                  |    |           |
| GH3                                | Twin         | 250        | 2                        | 2                        | 0                                 | •                          | •              | •          | •            | •           | •               |                | •       | •                | •  |           |
|                                    |              | 375        | 2                        | 2                        | 0                                 | •                          | •              | •          | •            | •           | •               |                | •       | •                | •  |           |
|                                    |              | 500        | 2                        | 2                        | 0                                 | •                          | •              | •          | •            | •           | •               |                | •       | •                | •  |           |

Example: GH3 Twin 250 220 (xxxxx)

| GH3 | Twin | 250 | 2 | 2 | 0                             |
|-----|------|-----|---|---|-------------------------------|
|     |      |     |   |   | w/o horizontal drive motors   |
|     |      |     |   |   | 2 lifting motors              |
|     |      |     |   |   | 2 lifting straps              |
|     |      |     |   |   | Safe Working Load SWL: 250 kg |
|     |      |     |   |   | Twin                          |
|     |      |     |   |   | Ceiling hoist, type GH3       |

| GH3 Twin               |                |
|------------------------|----------------|
| Lifting speed          |                |
| 85 kg load             | 60 mm/sec.     |
| 150 kg load            | 60 mm/sec.     |
| Max capacity load, SWL | 55 mm/sec.     |
| Max 5 kg load          | 60/100 mm/sec. |

### Number of lifts and Intermittent

Max. number of lifts in series : 55 with 85 kg/1000 mm  
 Charging time : 4 hours  
 Intermittent : 2 min. ON/18 min. OFF

Max. number of lifts in series : 21 with 250 kg/1000 mm  
 Charging time : 4 hours  
 Intermittent : 2 min. ON/18 min. OFF

Max. number of lifts in series : 21 with 375 kg/1000 mm  
 Charging time : 4 hours  
 Intermittent : 2 min. ON/18 min. OFF

Max. number of lifts in series : 21 with 500 kg/1000 mm  
 Charging time : 4 hours  
 Intermittent : 2 min. ON/18 min. OFF