

Hi-Loo

Toilet seat raiser with brackets.

Toilettensitzerhöhung mit Klammern.

Art.nr: 8030 1065	6 cm (without lid.)
8030 1067	6 cm (with lid.)
8030 1105	10 cm (without lid.)
8030 1101	10 cm (with lid.)

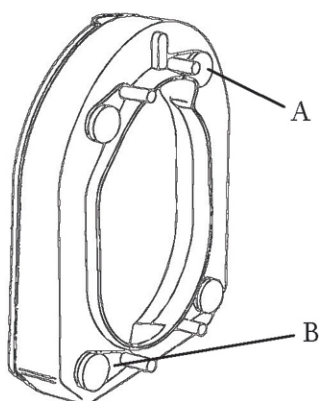

- A) Fixing screw (covered in friction rubber)
 B) Mounting bracket

1.

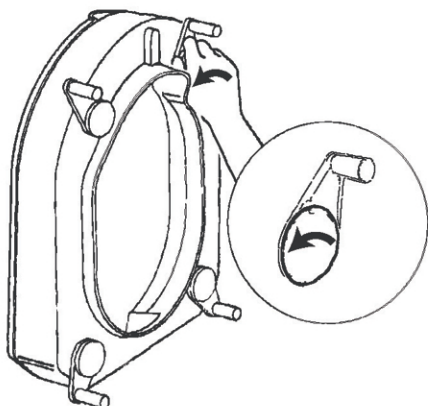

Undo the four fixing screws by turning them anticlockwise.
 The screws should be loosened only.
 Do not remove completely!

2.

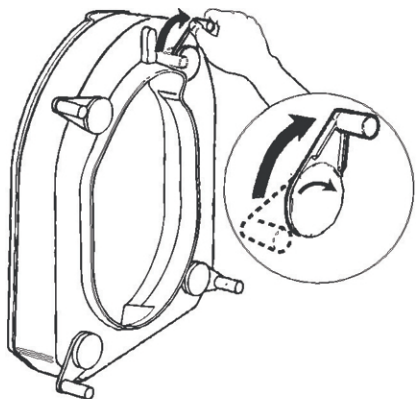

Then move the four brackets towards the outside of the seat.
 The screws will tighten until they click into place.

78271D

09-11-25

Etac AB, Box 203, SE-334 24 Anderstorp
 Tel. +46/371-58 73 00, Fax. +46/371-58 73 90

www.etac.com

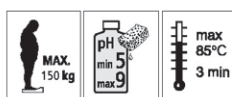

3.

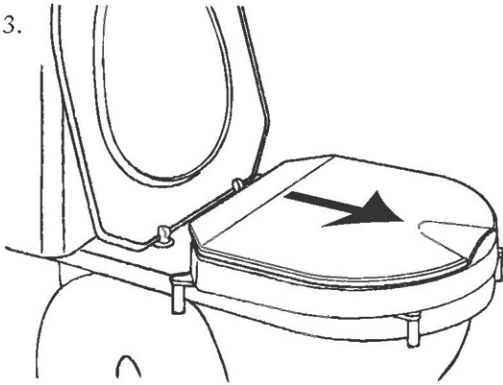

Lift the toilet lid. Place the Hi-Loo on the toilet bowl and adjust it until there is contact at the front of the bowl.

4.

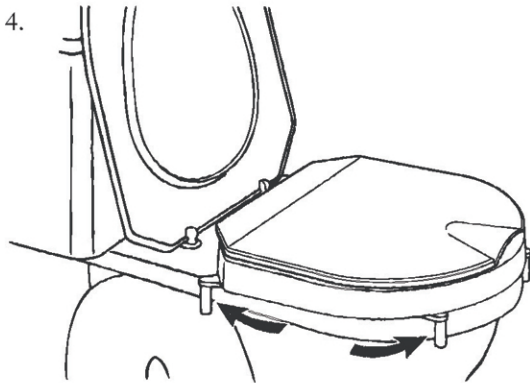

Turn the rear and front brackets at the side towards the bowl.

5.

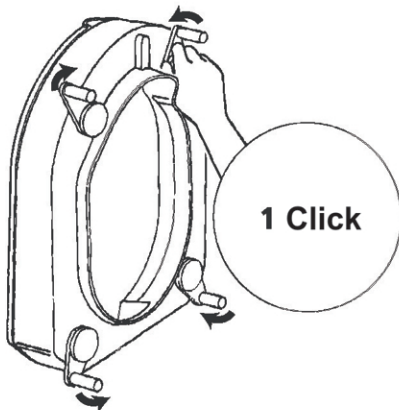

Slowly lift the Hi-Loo away from the bowl. Turn all four brackets one click inwards. Now tighten the screws.

Important: The brackets must remain in position!

6.

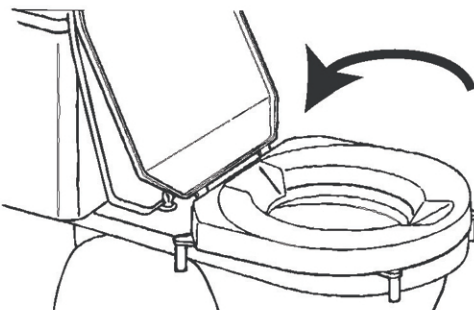

Attach the Hi-Loo to the bowl, front brackets first. Then use downward pressure to secure the rest of the Hi-Loo to the bowl. Check it is securely attached.

78271D

09-11-25

Etac AB, Box 203, SE-334 24 Anderstorp

Tel. +46/371-58 73 00, Fax. +46/371-58 73 90

www.etac.com