

EVOCARE AUSTRALIA PTY LIMITED

A.B.N. 98 078 566 604

Trading as **EVOCARE** and **L&M EQUIPMENT**

P.O. Box 1144, Stafford Qld. 4053

Ph: 07 3355 8000 Fax: 07 3355 5043

Website: <http://www.evocare.com.au>

E-Mail: sales@evocare.com.au

workshop@evocare.com.au



Quality
ISO 9001

Theatre Carts



USER GUIDE and MAINTENANCE MANUAL



www.evocare.com.au

Phone:07 33558000 Fax:07 33555043



Specifications:

Features

- Fully extendable drawers.
- Self locking mechanical spring latch mechanism built into the runner - prevents unlocked drawers from opening while in motion.
- Push Handle
- Wide wheel base
- Lightweight durable construction

Castors

- 125mm heavy duty polyurethane castors –swivel

Approximate Dimensions:

- Cabinet: Width 635mm, Depth 485mm, Height 1000mm
- Small Drawer: Width 540mm, Depth 400mm, Height 125mm
- Large Drawer: Width 540mm, Depth 430mm, Height 225mm

Finish: Epoxy powder coated

Bumper: Full wrap around P.V.C. Overall dimensions 810mm wide, 555mm deep.

Operation:

1. Workplace characteristics:

Aisle Conditions:

Keep aisles clear of clutter.

Aisles should be wide enough to allow the worker to stand behind the cart and push.

Corners that will accommodate the moving cart without stopping and starting.

Floor Condition

Keep floors in good repair.

Ensure floors are clean, free of debris, dirt, dust, miscellaneous liquids, or spills.

If floors are very uneven, consider using powered carts.

Ramps

Consider use of power assists (a battery powered drive unit).

If multiple ramps are present, use brake on the cart to help the operator control heavy loads.

2. Cart Characteristics:

Wheels/Castors:

The harder castor/tyre generally decreases force to move requirements.

Carts have rounded tyres as wider tread generally increases force to move requirements.

(Optional larger diameter castor. Increasing the diameter of the castor generally decreases force requirements).

Note: pneumatic wheels should not be used for heavy loads as they may compress and substantially increase the force to move requirements.

Handles

It is recommended fixed horizontal handles should be at a height between 910mm and 1120mm above the floor. Carts are 960mm.

Use swivel castors on the same end of the cart as the handle.

3. Operator Training/Experience:

Operators should be trained on appropriate body positioning for the type of cart and load being handled.

Operators should receive training on how to manoeuvre heavy loads.

Operators should walk at an appropriate cart speed - recommended speeds should match a typical walking pace (3-4 km/h).

Maintenance

Specific Servicing Details

At each 6 monthly preventative maintenance service the following should be checked or serviced:

Check Castors: It is always best practice to remove all hair and lint from castors as soon as possible to allow free movement of all the wheels. The castors should be lubricated every 6 months, (use TAC-2 a CRC product). The castor head bearing will need lubrication; simply spray TAC-2 up into the bearing while rotating the castor. To do this the wheel must be unbolted and removed from the castor frame. TAC-2 can then be sprayed into the hub to lubricate the internal bearings. Check any loose nuts and bolts and tighten accordingly. If there are any signs of damage or wear arrange for replacement parts.

Check operation of drawers and runners

Clean & lubricate drawer runners

Check operation of drawer lock assembly

Check frame for structural problems

Check overall safety

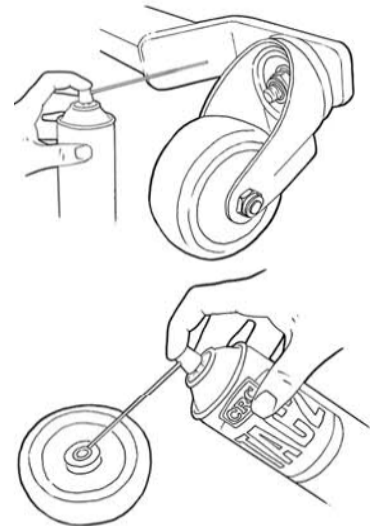

Cleaning

Theatre carts can be cleaned with an antiseptic solution in accordance with acceptable Infection Control Guidelines.

Warranty & Service Contract

The carts are covered under a 3 year warranty policy. This covers all parts and labour, but not freight.

Contact Evocare for details on Service Contracts.