



Redefining Patient Handling

Distributor



Journey



Joerns.co.uk

The Oxford[®] Journey lift is an ultra compact, portable folding stand aid with best-in-class functionality. It is compact and lightweight allowing care-givers to manoeuvre in tight spaces and can be folded for easy storage and transportation. The unique adjustable cow-horn mechanism supports a wider range of patient heights and sizes, allowing your facility to have one lift that meets the needs of many.

Key Features

- Safe Working Load 155kg / 24st / 342lbs
- Compact folding design for easy storage and transportation
- Unique adjustable cow-horn function
- Ergonomic design considerations
- Smart[™] Monitor diagnostic control system
- Contoured, height adjustable knee pad
- Removable foot tray for walking/rehabilitation activity



The Journey has the option of both a Standing or Transport sling, providing the carer with the option of performing various care duties including:

- Standing
- Toileting
- Point to point transfers
- Walking and rehabilitation activity.

Folding design

Unlike other stand aids on the market, the Journey can fold making it easy to transport and store. This functionality gives active users the option to travel outside the confines of their own home.



Unique adjustable cow-horn

The Journey's unique adjustable cow-horn ensures maximum flexibility and improved patient comfort. With three cow-horn height options, the Journey can support a wider range of patient heights and sizes.

Simply pull back the trigger mechanism on the boom and select the required cow-horn height

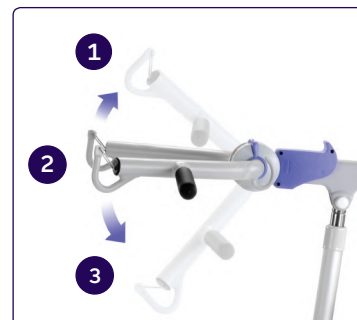

Ergonomic design considerations

5 The Journey was designed with the five key principles of moving and handling in mind. This direct correlation ensures Oxford's lift designs are simple, safe and above all comfortable to use.

This view is shared by our clinical consultant team, who have assisted us in conducting detailed usability surveys to ensure the Journey meets the true needs of the patient, carer and the environment in which it operates.

- 1 Get close to the load
- 2 Use a wide stable base
- 3 Ensure a comfortable firm grasp
- 4 Keep spine close to neutral
- 5 Make sure movement is smooth



Foot 'push pad' helps reduce the force needed to initiate forward movement.



Over-sized push handle for improved handling and manoeuvrability.



Hand control clip ensures convenient storage when not in use.



Smart™ Monitor

The Smart™ Monitor control system records the exact amount of work completed by the actuator each and every time the lift is used, regardless of a patient's weight or lift height covered. The intelligent system advises the user to schedule key maintenance helping to ensure your lift remains in optimum condition.

- Identifies total lift actuations and work completed
- Identifies lift overloads (exceeding SWL)
- Identifies service interval periods
- Increases patient safety and product service life

Removable foot tray

By removing the foot tray, the Journey transforms into a rehabilitation aid that allows a patient to fully stand. Once standing, the patient can be encouraged to walk independently.



Height adjustable knee pad

The Journey's contoured knee pad is height adjustable to ensure the patient feels comfortable and fully supported during transfer. A retractable safety belt provides additional support for patients needing further reassurance.

Technical Specifications

Specifications	Imperial	Metric
Safe Working Load	341 lbs	155 kgs
Maximum Overall Length	39.4 inches	1000 mm
Minimum Overall Length	36.8 inches	935 mm
Maximum Overall Height	63.0 inches	1600 mm
Minimum Overall Height	44.5 inches	1130 mm
Height (Folded)	20.5 inches	525 mm
Depth (Folded)	41.0 inches	1040 mm
Widest Point (Between support handles)	26.8 inches	680 mm
Maximum Height to Attachment Point	60.2 inches	1530 mm
Minimum Height to Attachment Point	28.4 inches	720 mm
Turning Radius	45.1 inches	1145 mm
Legs Open - External Width	38.2 inches	970 mm
Legs Open - Internal Width	34.5 inches	875 mm
Legs Closed - External Width	27.0 inches	685 mm
Legs Closed - Internal Width	22.2 inches	590 mm
Overall Height of Legs	4.3 inches	110 mm
Ground Clearance	1.2 inches	30 mm
Front Twin Castors	3.0 inches	75 mm
Rear Braked Castors	4.0 inches	100 mm

Weights	Imperial	Metric
Mast, Base & Boom Assembly	82.4 lbs	37.4 kgs
Power Pack	6.2 lbs	2.8 kgs
Total	88.6 lbs	40.2 kgs
Base Assembly	30.2 lbs	18.2 kgs
Mast & Boom Assembly (not including battery)	42.3 lbs	19.2 kgs

Specifications may vary due to manufacturing tolerances.

Electrical Specifications

Battery 1 x 24 volt rechargeable sealed lead acid type
 Battery capacity 2.9 Ampere hours
 Charger rated input 100 - 240 V AC / 50 / 60 Hz
 Charger rated output 29.5 V DC Max 19W / IPX5

Electrical Shock Protection

Charger - class II
 Lift - internal power source



Degree of shock protection

Charger - Type B
 Lift - Type B

Intended operating environment

>+5° <+40°
 Outside this environment functionality and safety may be compromised

Warranty

Please contact your authorised distributor for details.

Distributor

EVOCARE AUSTRALIA PTY LIMITED

A.B.N. 98 078 566 604

Trading as **EVOCARE** and **L&M EQUIPMENT**

P.O. Box 1144, Stafford Qld. 4053

Ph: 07 3355 8000 Fax: 07 3355 5043

Website: <http://www.evocare.com.au>

Email: sales@evocare.com.au

workshop@evocare.com.au

warehouse@evocare.com.au

accounts@evocare.com.au



Scan me!

